

Customer: _____	Contact person: _____
Postcode / City: _____	Commission No.: _____
Country: _____	Quantity: _____
Phone: _____	Requested supply date: _____
E-mail: _____	

Vehicle designation and OEM specific number (mandatory):

Vehicle designation: _____

Mercedes: _____ BM: _____ Scania: _____

MAN: _____ IVECO: _____

DAF: _____ Renault: _____

Volvo: _____

Coupling (K = 360 mm) Coupling with analog sensor and DIN connector

RF50 AM CD RF40 AM CD Notes: _____

A) Locking indicator in the driver's cabin

1) 12m cable for display integration 2) Ringfeder display panel incl. 12m cable 3) Q9A adapter

ATTENTION! Parameterization necessary / check vehicle pre-installation

B) Locking indicator outside the driver's cabin

4a) Display set incl. 12 m cable integration 4b) Display without cable (if required in addition to the display in the driver's cabin)

Characteristic values of vehicle combination:

D value: _____ kN

Dc value: _____ kN

V value: _____ kN

Vertical load (S): _____ kg

Dimensions:

LW: _____ mm

BH: _____ mm

RPH: _____ mm

SP: _____ mm

A1: _____ mm

Side plates without hole pattern					
Type:	Width (B):	Free usable plate height (FH) / Height (H):	Gmax	Gmin	
EDF250	350	415 / 500	255	245	<input type="checkbox"/>
		455 / 540	295		<input type="checkbox"/>
		495 / 580	300		<input type="checkbox"/>
EDF300	375	515 / 600	355	300	<input type="checkbox"/>
		545 / 630	380		<input type="checkbox"/>
	400	515 / 600	355		<input type="checkbox"/>
		545 / 630	380		<input type="checkbox"/>
EDF350	450	645 / 730	460	380	<input type="checkbox"/>
		665 / 750	460		<input type="checkbox"/>

Side plates with hole pattern

UK*: _____ mm

Enclose sketch or chassis drawing (.dxf, if possible)!

* Information is mandatory for hole pattern inquiries!

Mounting/surface

Standard as illustrated

Side plate turned around 180°

Not mounted

Hot zinc

EC (black)

Personal responsibility of the vehicle manufacturer or consumer:

The relevant statutory regulations of the country where the equipment is put into circulation, the installation guidelines of the corresponding vehicle manufacturer and the assembly and operating instructions of the manufacturer for the above equipment for the installation must be complied with.

Technical information

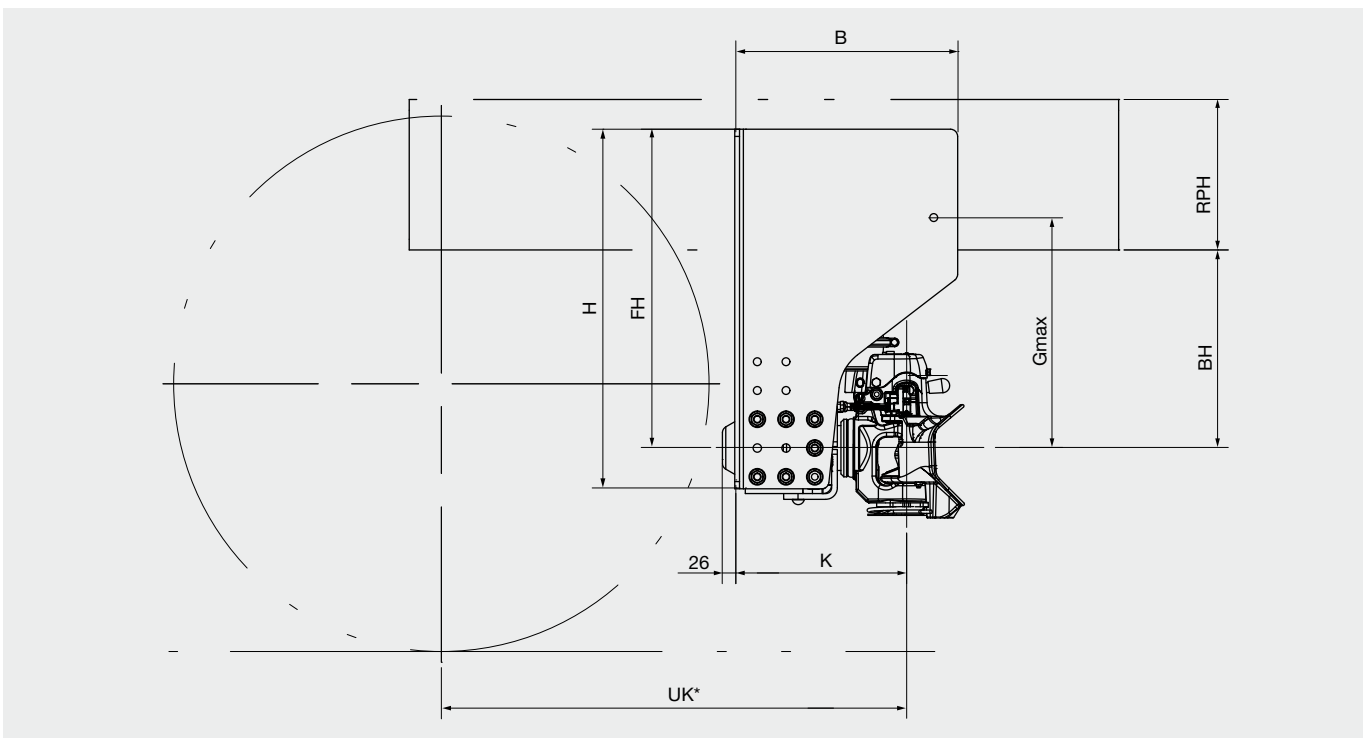
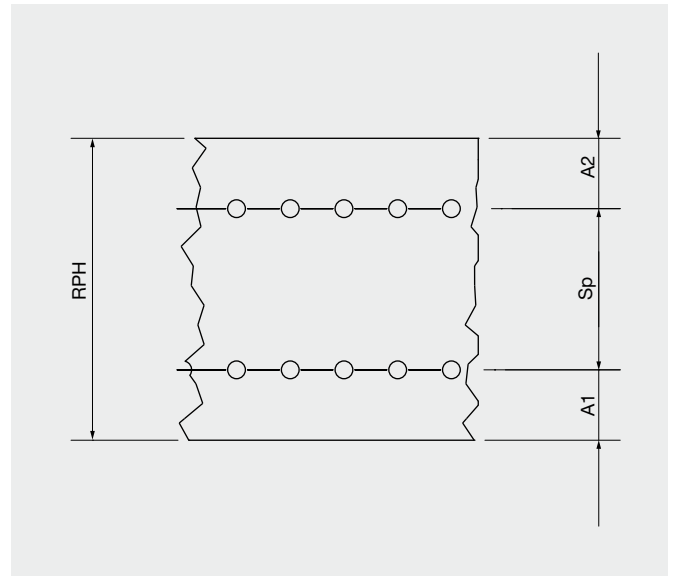
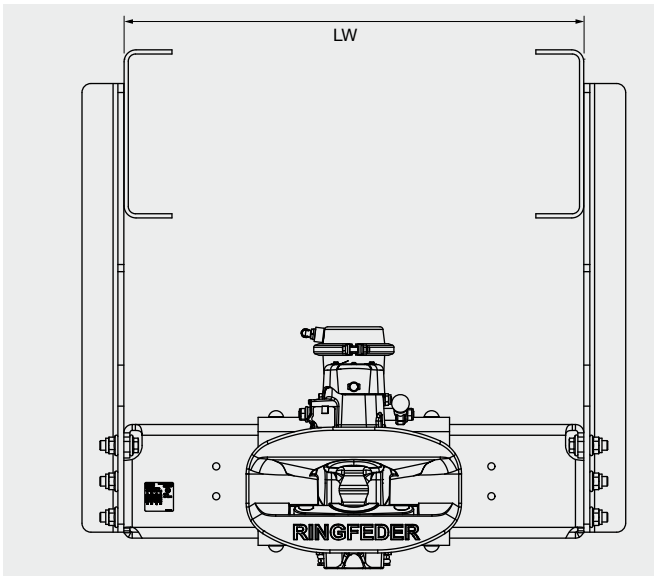

Subject to technical changes · 05/2024

Explanations for the item “Vehicle designation and OEM specific No.”

The following must be entered in the fields for the OEM-specific No.:

Mercedes: MB order number (1st field) and type (2nd field)

Scania: Factory order number

MAN: MAN 8 actuator / 8 pin code

IVECO: Attach chassis drawing incl. frame drill holes in dxf

DAF: Production number

Renault: Order number

Volvo: OM or FO number